

# New Polling Place at Bard College: Visual Evidence



# Speakers

- Adrian Costa, Election@Bard and Speaker for the Student Body
- Sadia Saba, Election@Bard
- Sarah deVeer ('17), Bard Center for Civic Engagement
- Jonathan Becker, Executive Vice President and Director Center for Civic Engagement

# **The Polling Site: St. John's, Barrytown**







# **The Polling Site:** **Bard College MPR**









# **The Layout: Barrytown vs. Bard College MPR**

## From State Survey...

## ...To Election Day Reality

Barrytown during Election Day 2012

This state-mandated survey was completed in 2010.

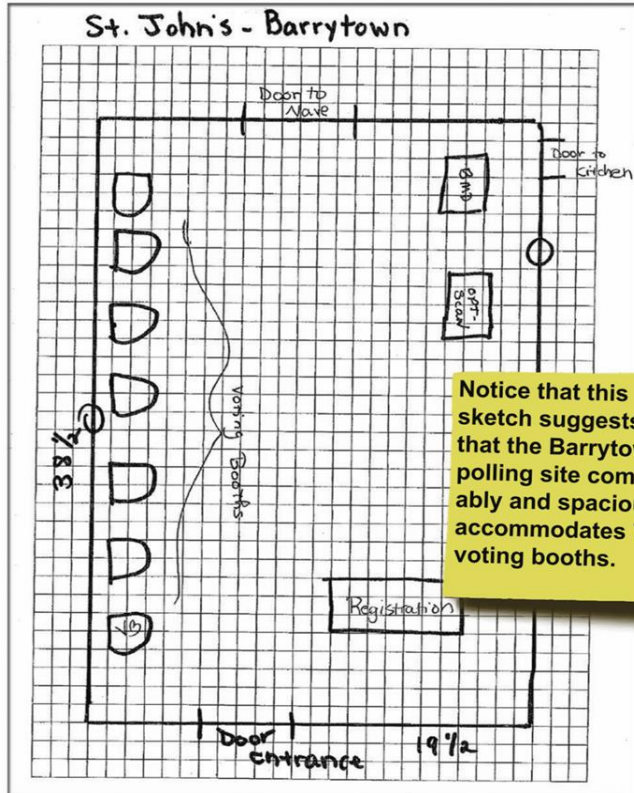

Notice that this sketch suggests that the Barrytown polling site comfortably and spaciouly accommodates 7 voting booths.

Taken two years after the Spatial Requirement Survey, these images show the inconsistencies between the Survey and actual site set-up. Even during a presidential election year, when facilities are better organized in anticipation of large voter turnouts, conditions were unsatisfactory at Barrytown.

Obtained from a 2012 Bard Free Press video of a confrontation regarding voters purged from the rolls.



As indicated by the patterned arrows, the 4 grey ballot privacy booths are spaced closely together due to a lack of available floor space at the site. This configuration leaves little room for voters using mobility aids.

Length  
of  
space  
is 38.5'

Width of space is 19.5'

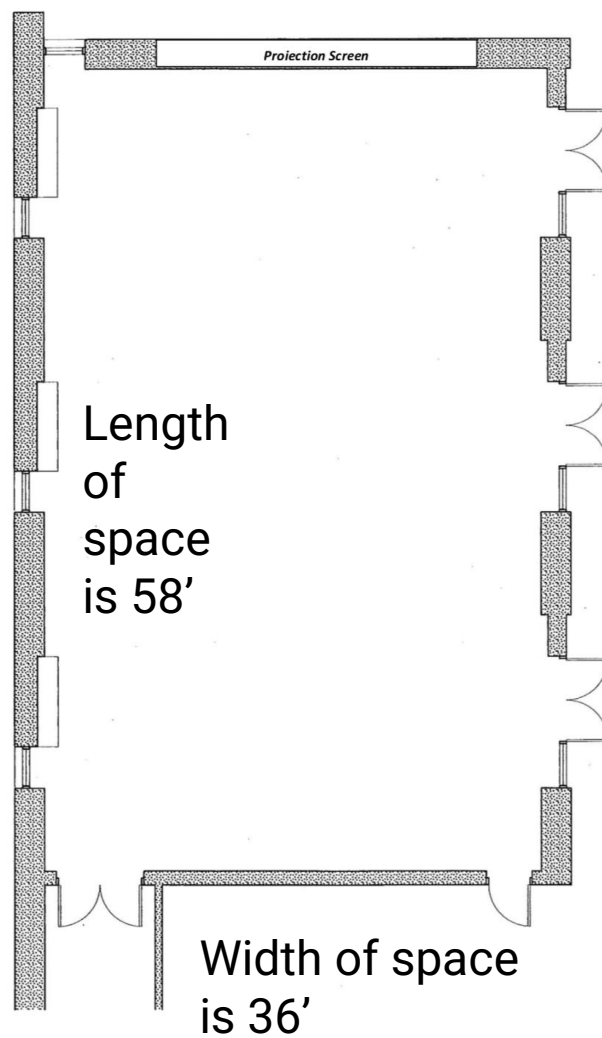

# Bard Multipurpose Room vs. St. John's, Barrytown

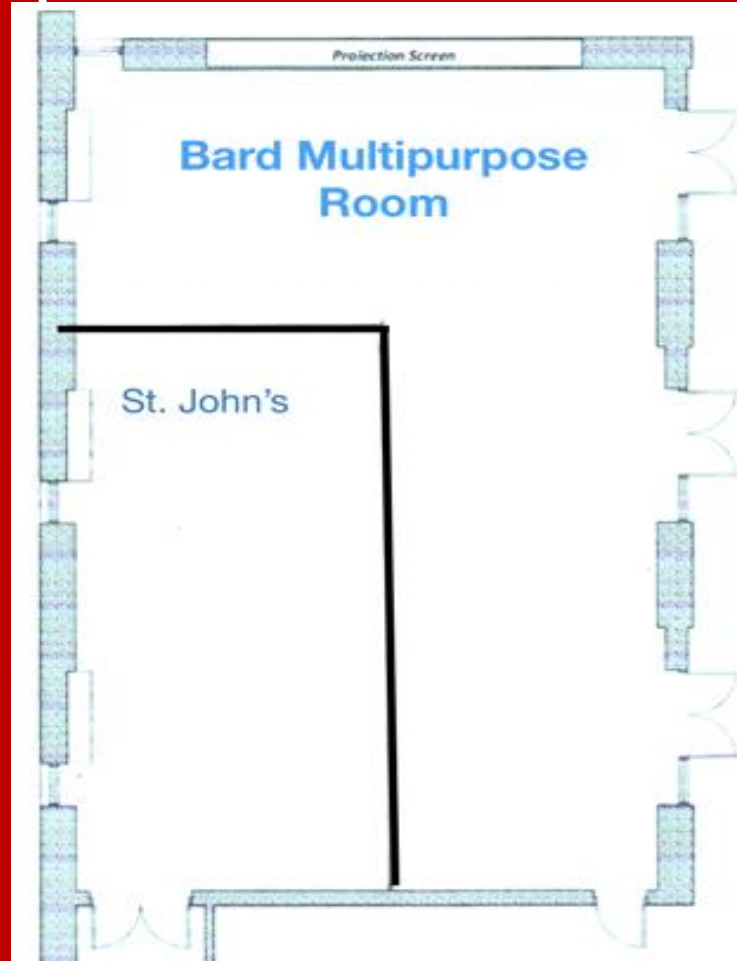

**Waiting to Vote:  
St. John's, Barrytown**









1106 County Rd 103

Barrytown, New York



Google

Street View

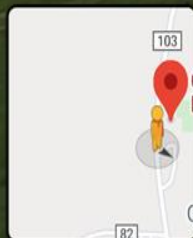

Google

County Rd 103



**Waiting to Vote:  
Bard College MPR**



# The Road to Vote: St. John's







**Bus Stop**





# **Voting, Democracy and Youth**

Voters in Last Federal Election	
Country	% Voting Age Population
Belgium	87.21%
Sweden	82.61%
Germany	69.11%
France	67.94%
UK	63.25%
US	55.70%



## Turnout by Age

